







- |   |                              |   |                         |
|---|------------------------------|---|-------------------------|
|    | ARENA                        |    | WASHROOMS               |
|    | BLEACHERS                    |    | PLAY STRUCTURE          |
|  | MULTI-PURPOSE ROOMS 1 & 2    |  | STORAGE/MECH., & ELECT. |
|  | MULTI-PURPOSE ROOM MEZZANINE |  | RUNNING TRACK           |



**hildebrandarchitectureinc**  
 844 Avenue De L'Église Winnipeg MB R3V 1H1 204-951-3811

**Design**  
 INTEGRITY  
 1000 W. Main Street, Suite 100  
 Winnipeg, MB R2M 2K5  
 Tel: 204-951-1111  
 Fax: 204-951-1112  
 Email: info@hildebrandarchitect.com

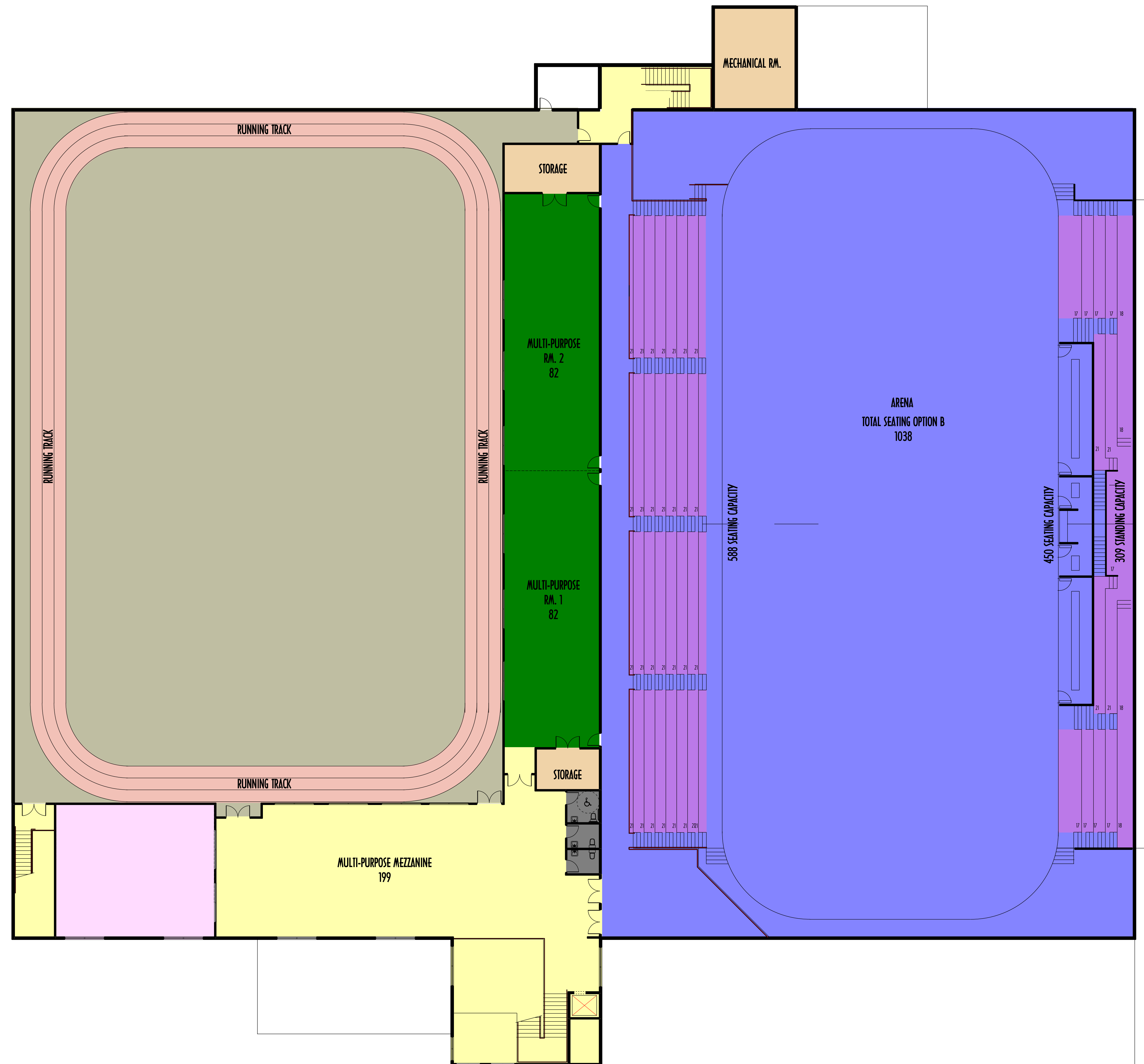
**W**  
 200 W. Main Street  
 Winnipeg, MB R2M 2K5  
 Tel: 204-951-1111  
 Fax: 204-951-1112  
 Email: info@winnipeg.ca

**SECOND FLOOR PLAN OPTION B**

MAIN FLOOR 69,697 SQ. FT.  
 SECOND FLOOR 17,032 SQ. FT.  
 TOTAL 86,729 SQ. FT.